

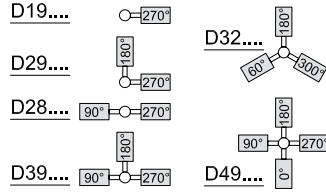

LL-RTS Round Tapered Steel - Made in USA



Features



- T20.... 2.38" ϕ x 4.00" TALL
- T25.... 2.88" ϕ x 4.00" TALL
- T30.... 3.50" ϕ x 6.00" TALL
- T35.... 4.00" ϕ x 6.00" TALL
- OT.... OPEN TOP
- TSP.... SPECIAL SIZE TENON

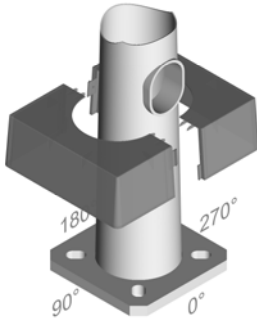

NOTE: ANCHOR BOLT PATTERNS ARE SUBJECT TO CHANGE. CONSULT FACTORY PRIOR TO CONSTRUCTION.

Pole Shaft:	The pole shall be a one section design conforming to ASTM A595 Grade A or ASTM A572 Grade 55 with a constant taper rate of .14 in/ft. Pole will be cylindrical in cross-section and will have a full length longitudinal weld.
Base Plate:	The base plate is fabricated from a structural quality hot rolled carbon steel plate that meets or exceeds ASTM A-36 with a minimum yield strength of 36,000 psi. The base plate telescopes the pole shaft and is circumferential welded top and bottom.
Base Cover:	The two-piece standard full base cover is fabricated from ABS plastic. Optional two-piece steel base cover also available.
Anchor Bolts:	Anchor bolts conform to ASTM F1554 Grade 55 and are provided with two hex nuts and flat washers. Bolts have an "L" bend on one end and are galvanized a minimum of 12" on the threaded end in accordance with ASTM A-153.
Handhole:	A reinforced hand hole, having a nominal opening of 3"x 5" or 4" x 6.5" will be installed 18" above the base plate. A hand hole cover with hardware will be included along with grounding provisions.
Pole Top:	Each pole will be provided with a welded top plate and tenon or top cap for poles receiving drilling for side mount fixtures.
Finish:	Standard color finishes shall be coated with TGIC polyester powder or hot dip galvanized to ASTM A-123 specifications.



Project Name	
Catalog #	
Job Type	
Prepared By	
Notes	

Ordering Information

Catalog Number	Pole Dimensions					Base Details							Base Reaction														
	HGT (ft)	BASE OD (in)	TOP OD (in)	Wall Thk (GA)	Structure weight (lbs)	BASE TEMPLATE			ANCHOR BOLTS				Axial (lbs)		Axial (lbs)		Axial (lbs)		Axial (lbs)		Axial (lbs)		Axial (lbs)		Axial (lbs)		
						SQ (in)	THK (in)	Bolt Circle	Template	Ø	L	EPA	WGT	EPA	WGT	EPA	WGT	EPA	WGT	EPA	WGT	EPA	WGT	EPA	WGT		
LL-RTS-20-59-11	20	5.9	3.1	11	140	10.00	0.88	8.50-9.50	ABT-090-4	1	36	19.3	482	15.1	377	12.2	305	10.5	262	8.8	220	7.4	185	6.3	157	5.5	138
LL-RTS-20-65-11	20	6.5	3.7	11	160	10.5	0.88	9.00-10.00	ABT-095-4	1	36	24.2	605	19.3	482	15.6	390	13.5	335	11.2	280	9.5	238	8.1	203	6.9	173
LL-RTS-25-59-11	25	5.9	2.4	11	155	10	0.88	8.50-9.50	ABT-090-4	1	36	12.5	312	9.9	247	8	200	6.9	173	5.7	143	4.8	119	4.1	103	3.5	88
LL-RTS-25-70-11	25	7	3.5	11	200	10.88	0.88	9.50-10.50	ABT-100-4	1	36	20.3	507	16.2	405	13.1	327	11.2	280	9.4	235	7.8	194	6.7	168	5.7	143
LL-RTS-25-70-7	25	7	3.5	7	280	10.88	1	9.50-10.50	ABT-100-4	1	36	30.5	760	24	625	19.8	495	16.5	413	13.9	348	11.7	293	10	250	8.5	213
LL-RTS-30-66-11	30	6.6	2.4	11	200	10.5	0.88	9.00-10.00	ABT-095-4	1	36	11.7	292	9.3	232	7.5	187	6.5	163	5.4	135	4.6	115	3.9	98	3.3	83
LL-RTS-30-80-11	30	8	3.8	11	265	11.5	0.88	10.50-11.50	ABT-110-4	1	36	18.9	473	14.9	373	12	300	10	250	8.4	210	6.8	168	5.7	143	4.7	118
LL-RTS-30-80-7	30	8	3.8	7	380	11.5	1.25	10.50-11.50	ABT-110-4	1.25	42	33.5	838	27	675	22	550	18.4	460	15.3	381	13	325	11	275	9.3	233
LL-RTS-35-73-11	35	7.3	2.4	11	250	11.25	0.88	10.00-11.00	ABT-105-4	1	36	11.2	280	8.9	222	7.1	177	6.3	156	5.3	131	4.4	110	3.8	95	3.1	78
LL-RTS-35-85-11	35	8.5	3.6	11	315	12	1	11.00-12.00	ABT-115-4	1	36	18.9	472	15.1	377	12.2	305	10.5	263	8.7	218	7.2	180	5.9	148	4.8	120
LL-RTS-35-95-11	35	9.5	4.6	11	370	13	1	12.50-13.50	ABT-130-4	1	36	23.2	580	18.2	455	14.5	363	12	300	9.7	243	7.8	194	6.3	156	5.2	130
LL-RTS-39-78-11	39	7.82	2.4	11	285	11.5	0.88	10.50-11.50	ABT-110-4	1	36	10.7	267	8.5	212	6.6	165	5.7	143	4.5	113	3.7	93	2.9	73	2.3	58
LL-RTS-39-90-11	39	9	3.5	11	355	12.38	1	12.00-13.00	ABT-125-4	1	36	17.2	430	13.5	338	10.8	270	9	225	7.3	183	5.8	144	4.7	118	3.8	95
LL-RTS-39-90-7	39	9	3.5	7	515	12.38	1.25	12.00-13.00	ABT-125-4	1.25	42	28.5	715	23	575	19	475	15.8	394	13.2	330	10.8	269	9	225	7.7	193
LL-RTS-45-10-11	45	10	3.7	11	450	14	1	13.00-14.00	ABT-135-4	1	36	17.4	435	13.5	338	10.6	265	8.8	219	7	175	5.5	138	4.3	108	3.2	80
LL-RTS-45-10-7	45	10	3.7	7	650	14	1.25	13.00-14.00	ABT-135-4	1.25	42	28.5	715	23	575	19	475	16	400	13.3	333	11	275	9	225	7.4	185
LL-RTS-45-11-7	45	11	4.7	7	780	16.5	1.5	14.50-15.50	ABT-150-4	1.25	42	35.7	893	28	700	22.3	558	18.7	468	15	375	12.2	305	10	250	8.1	203
LL-RTS-50-10-11	50	10	3	11	475	14	1	13.00-14.00	ABT-135-4	1	36	13.2	330	10.6	265	8.3	208	6.9	173	5.4	135	4.1	103	3.1	78	2.2	55
LL-RTS-50-10-7	50	10	3	7	680	14	1.25	13.00-14.00	ABT-135-4	1.25	42	20.5	512	16.5	412	13.6	340	12.1	303	10.2	255	8.7	218	7.3	183	5.9	148
LL-RTS-50-11-7	50	11	4	7	812	16.5	1.5	14.50-15.50	ABT-150-4	1.25	42	29.9	748	23.5	588	18.6	465	15.6	390	12.5	313	10	250	8	200	6.5	163
LL-RTS-50-13-7	50	13	6	7	1020	18	1.5	17	ABT-170-4	1.5	54	50.4	1260	39.7	992	31.4	785	26.2	655	21.1	528	17	425	14	350	11.4	285
LL-RTS-50-13-3	50	13	6	3	1335	18.5	1.75	17.5	ABT-175-4	1.75	54	69.2	1730	55	1375	44.2	1105	36	900	29.8	745	24.6	615	20.4	510	17	425