

Keilton + autani

EFS106 Series

Plug and Play High Bay Sensor



EFS106-BH4
(Lens Sold Separately)



EFS106-AUX
(Lens Sold Separately)



EFS106-Z10
(Lens Sold Separately)

Description

EFS106 low voltage high bay sensors are ideal for Luminaire Level Lighting Control (LLLC/NLC5) applications. Featuring integrated daylight harvesting and PIR motion sensors, the EFS106 sensors are designed for pre-installation in linear high bay or UFO high bay luminaires. EFS106 sensors are equipped with the **AlgoH²** algorithm to maximize detection for high bay applications up to 40 ft without false triggers.

Features

- Plug and Play with sensor port pre-installed
- Bluetooth network technology
- Designed for High Bay applications
- **AlgoH²** algorithm enhances performance in high bay applications
- Built-in analog PIR sensor
- Replaceable lens options
- 12V DC input
- Daylight harvesting available

Requirements

- Lens sold separately
- Requires Dim-to-Off LED drivers with 12V AUX output
- Requires one of the BH4/SC01/Zhaga receptacles

Specifications

Input Voltage	DC 12V
Input Current	50mA Max
Input Power	0.6W
Output Voltage	DC 10V
Output Current	10mA Max
Output Power	0.1W
Dimming	Class 2, 0-10V DC 10mA Max
Sinking Current	10mA Max
Bluetooth Transmit	100ft Max
Radio Frequency	2.4GHz ± 75MHz
Bluetooth Version	4.2/5.0
Housing Material	UL 94-5VA
Detection Range	40-100ft
Mounting Height	20-50ft
Indoor/Outdoor Use	Indoor Use
Operating Temperature	-30°C to 55°C, -22°F to 131°F
Storage Temperature	-30°C to 85°C, -22°F to 185°F
IP Rating	IP40
Color	White, Black
Warranty	5 year warranty
Compliance	UL8750, RoHS

Safety
cULus Listed LED Controller
E504054
FCC ID: 2A26YLTKTVT2021
DID: D057145
DLC: NLTRC5KLOTN

Mating Receptacle (not included in the product package)



Ordering Information - EFS106 Series

Model	BASE	Color	Photocell Type	Bluetooth Version	Description
EFS106-BH4*	BH4	White	DLH**	5.0	Plug and Play High Bay Sensor
EFS106-AUX*	AUX				
EFS106-Z10*	Z10				

* The asterisk (*) denotes possible revision identifiers. Current revisions include B1, and C1 (e.g., EFS106-AUX.A0, EFS106-AUX.B1, EFS106-AUX.C1). All revision versions meet the specifications outlined in this datasheet. For specific revision information, please refer to product labeling or contact customer support. Revision updates represent minor improvements and do not affect core functionality or performance specifications.

** DLH = Daylight Harvesting

Z10 socket by others.

Ordering Information - Accessories

Model	Type	Description
HBL1-2-W	Lens	High Bay Lens 20ft to 40ft Mounting Height
HBL3-2-W	Lens	High Bay Lens 20ft to 50ft Mounting Height
MBL1-2-W	Lens	Middle Bay Lens
BH4	Base	BH4 Mating Receptacle
SC01	Base	Mating Receptacle
SC03	Base	Turnable Mating Receptacle

Wiring

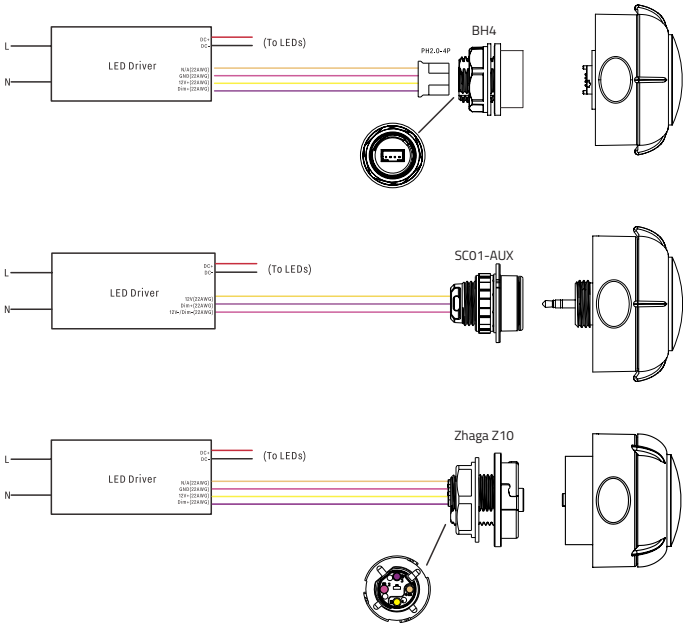

Socket Mounting Dimensions		1/2 inch US standard knockout
Size	T.P.I - inch	Major Dia. - inch
R1/2	14	0.825

Dimensions

Unit:inch/mm

EFS106-BH4

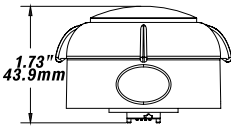

EFS106-AUX

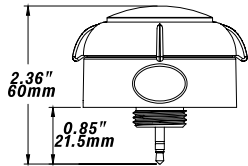

EFS106-Z10

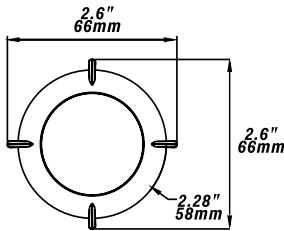
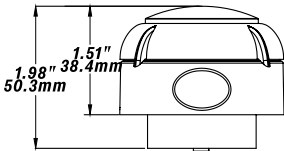

Dimensions - Accessories

BH4

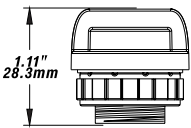

SC01-AUX

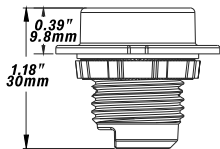

SC03-AUX

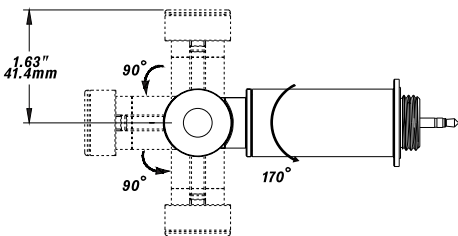
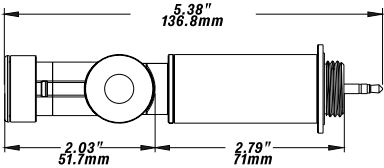

Socket Mounting Dimensions		1/2 inch US standard knockout
Size	T.P.I - inch	Major Dia. - inch
R1/2	14	0.825

Unit:inch/mm

HBL1

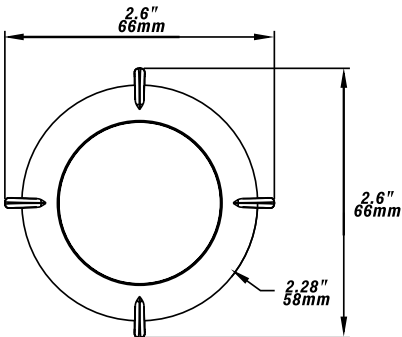
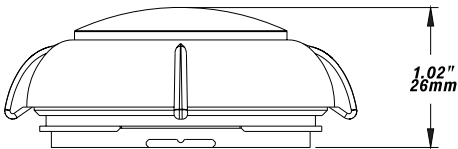

Coverage Side View

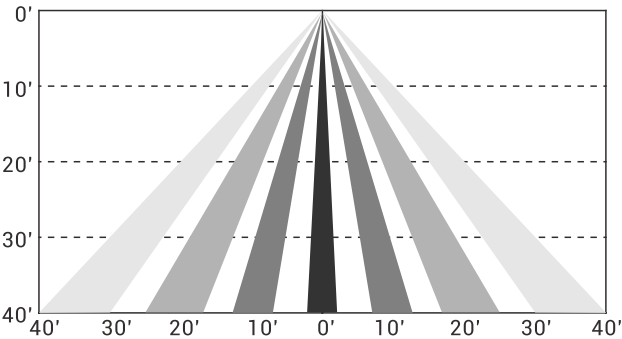

Coverage Top View

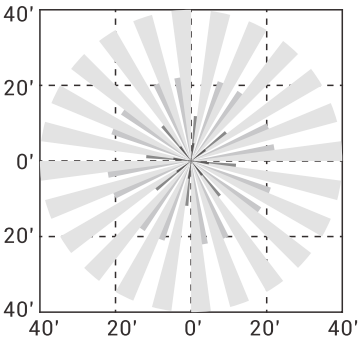

Height 40ft

Dimensions - Accessories

HBL3

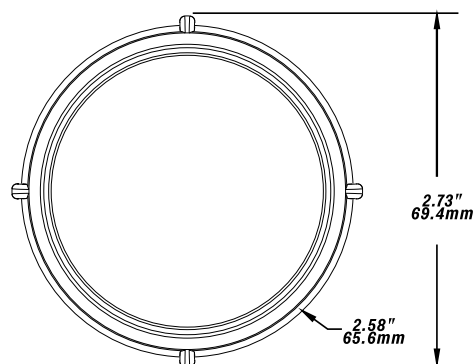
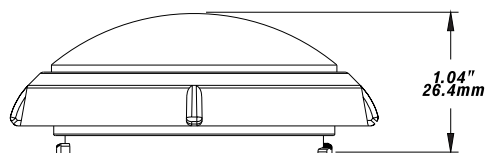

Coverage Side View

Coverage Top View

Detecting Spots For Ref

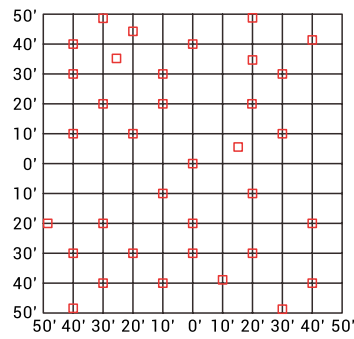
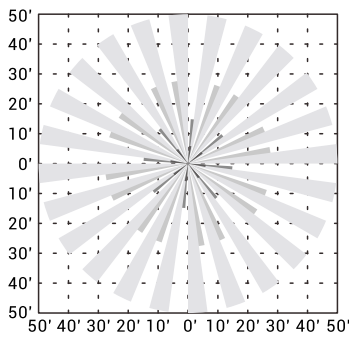
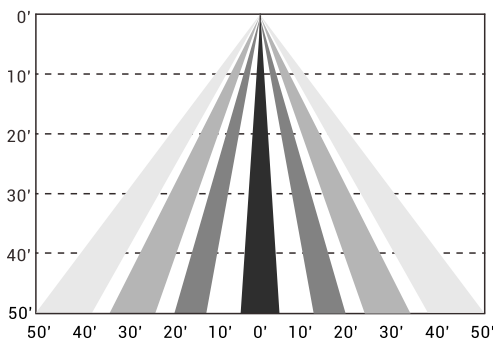

Height 50ft

HBL3 has more detected points than HBL1

Product Label



The Bluetooth word mark and logos are registered trademarks owned by Bluetooth SIG, Inc. and any use of such marks by LiteTrace is under license. Other trademarks and trade names are those of their respective owners.

App Download



Due to our continued efforts to improve our products, specifications are subject to change without notice.

Contact Us

7001 Columbia Gateway Drive, Suite 210, Columbia, MD 21046, USA

T: +1 443-320-2233 (M-F 9am-5pm ET)

E: support@autani.com

Revised on 5-20-2025