

Avanta Surface Linear Installation Instructions



Warning

RISK OF FIRE AND ELECTRICAL SHOCK. FIXTURE MUST BE INSTALLED BY A QUALIFIED ELECTRICIAN ONLY IN ACCORDANCE WITH NATIONAL, LOCAL BUILDING AND ELECTRICAL CODES. DISCONNECT POWER AT ELECTRICAL PANEL BEFORE SERVICING.

Vertical Surface Important

1. Read all instructions.
2. Install in accordance with national and local electrical code regulations.
3. This product is intended to be installed and serviced by a qualified, licensed electrician.
4. Do not install in wet locations. For dry and damp use only.
5. Turn off electrical power before installing or servicing fixture in any way.
6. To reduce the risk of fire and overheating, make sure all connections are tight.
7. Under no circumstances can the lighting fixture be covered with heat insulation gasket or similar materials.

Accessories

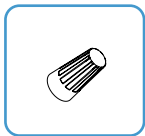

Wire Nut

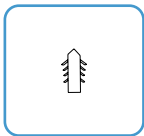

Anchor

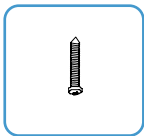

Screw PA4*30

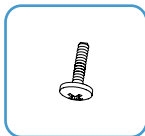

Screw
CM4X12



Power Cord

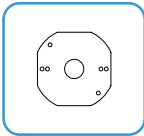

Surface Plate

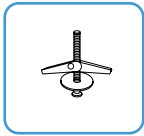

Butterfly
Drywall
Anchor

Wiring Diagram

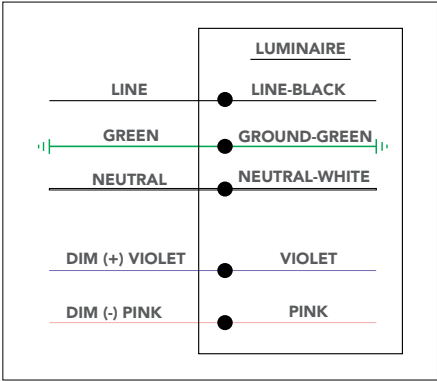

Avanta Surface Linear Installation Instructions



Installation Instructions:

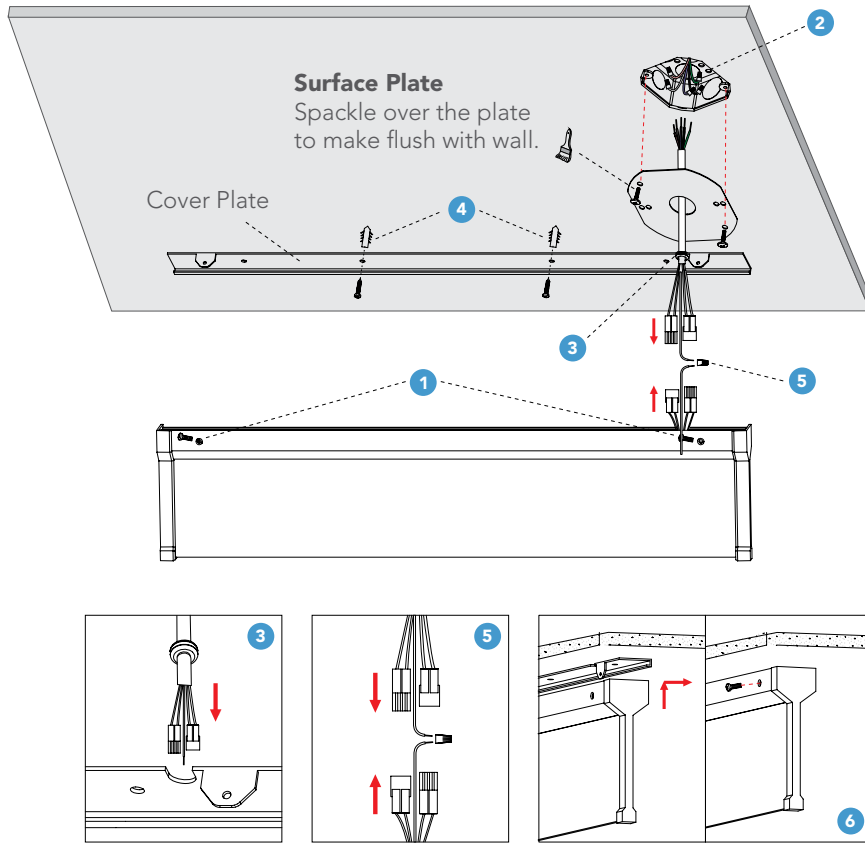

- 1 Take off the cover by screwdriver
- 2 Connect the wires of power cable (provided) with junction box by the wiring caps. Cover the junction box with Surface Plate and fix it with screws, then plaster.
- 3 Insert the power cord into the opening of cover as shown.

- 4 Fix the cover in the ceiling

Ceiling Type

Solid Ceiling (By Others)



Hole Diameter: 0.20"

Drywall Ceiling (By Others)

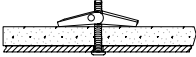

Hole Diameter: 0.47"

Mounting Point

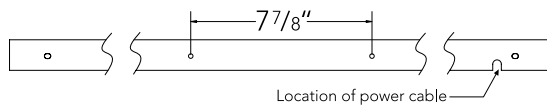

- 5 Connect wires by quick connectors and wiring caps, then hide all wires into the junction box.
- 6 Fix led luminaire on the cover with screws.

Wattage & CCT Adjustable By Dip Switch

| Length | High | Medium | Low |
|--------|---------|---------|---------|
| 3' | 4000 lm | 3000 lm | 2000 lm |
| 4' | 4000 lm | 3000 lm | 2000 lm |

Avanta Surface Linear Installation Instructions



Vertical Wall Mount

Important

- 1. Read all instructions.
- 2. Install in accordance with national and local electrical code regulations.
- 3. This product is intended to be installed and serviced by a qualified, licensed electrician.
- 4. Do not install in wet locations. For dry and damp use only.
- 5. Turn off electrical power before installing or servicing fixture in any way.
- 6. To reduce the risk of fire and overheating, make sure all connections are tight.
- 7. Under no circumstances can the lighting fixture be covered with heat insulation gasket or similar materials.

Accessories

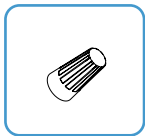

Wire Nut

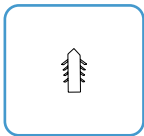

Anchor

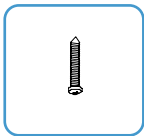

Screw PA4*30

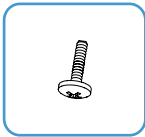

Screw
CM4X12



Power Cord

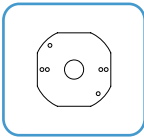

Surface Plate

Wiring Diagram

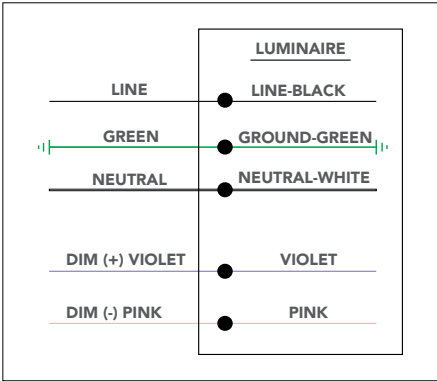

Avanta Surface Linear Installation Instructions



Installation Instructions:

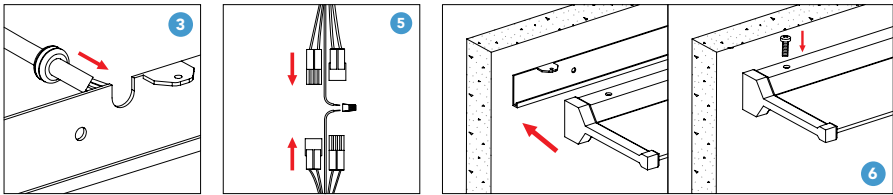
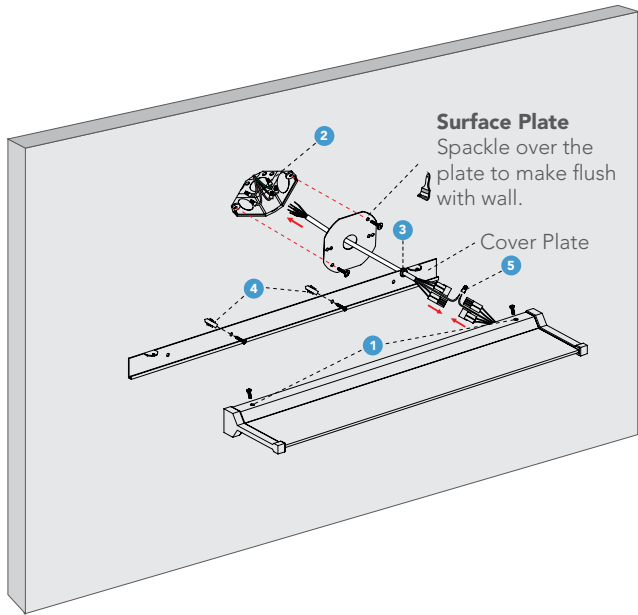

- 1 Take off the cover by screwdriver.
- 2 Connect the wires of power cable (provided) with junction box by the wiring caps. Cover the junction box with Surface Plate and fix it with screws, then plaster.
- 3 Insert the power cord into the opening of cover as shown.
- 4 Fix the cover in the ceiling

Ceiling Type



Hole Diameter: 0.20"

Mounting Point

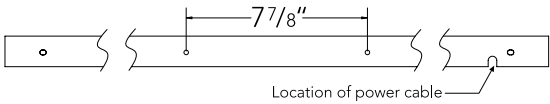

- 5 Connect wires by quick connectors and wiring caps, then hide all wires into the junction box.
- 6 Fix led luminaire on the cover with screws.

Wattage & CCT Adjustable By Dip Switch

| Length | High | Medium | Low |
|--------|---------|---------|---------|
| 3' | 4000 lm | 3000 lm | 2000 lm |
| 4' | 4000 lm | 3000 lm | 2000 lm |

Avanta Surface Linear Installation Instructions



Vertical Pendant Important

- 1. Read all instructions.
- 2. Install in accordance with national and local electrical code regulations.
- 3. This product is intended to be installed and serviced by a qualified, licensed electrician.
- 4. Do not install in wet locations. For dry and damp use only.
- 5. Turn off electrical power before installing or servicing fixture in any way.
- 6. To reduce the risk of fire and overheating, make sure all connections are tight.
- 7. Under no circumstances can the lighting fixture be covered with heat insulation gasket or similar materials.

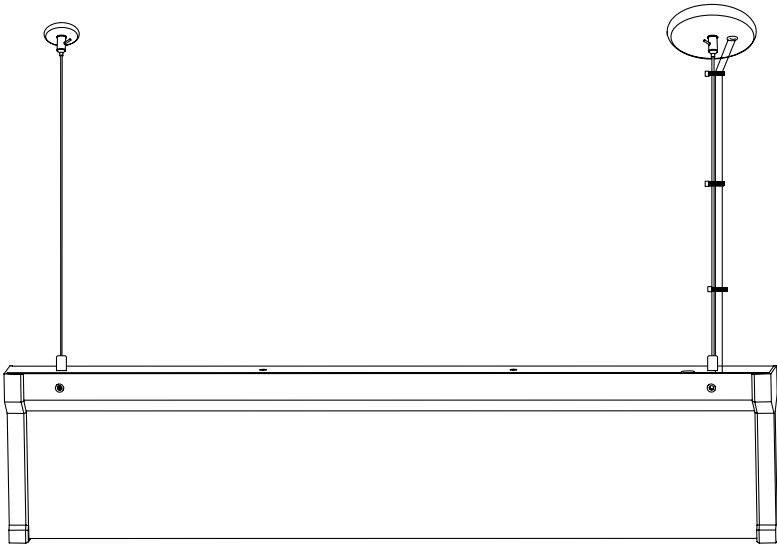

Wiring Diagram

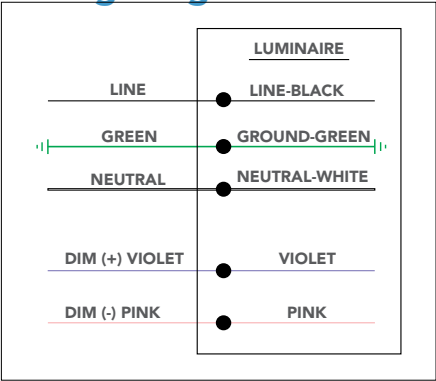

Wattage & CCT Adjustable By Dip Switch

| Length | High | Medium | Low |
|--------|---------|---------|---------|
| 3' | 4000 lm | 3000 lm | 2000 lm |
| 4' | 4000 lm | 3000 lm | 2000 lm |

Avanta Surface Linear Installation Instructions



Installation Instructions:

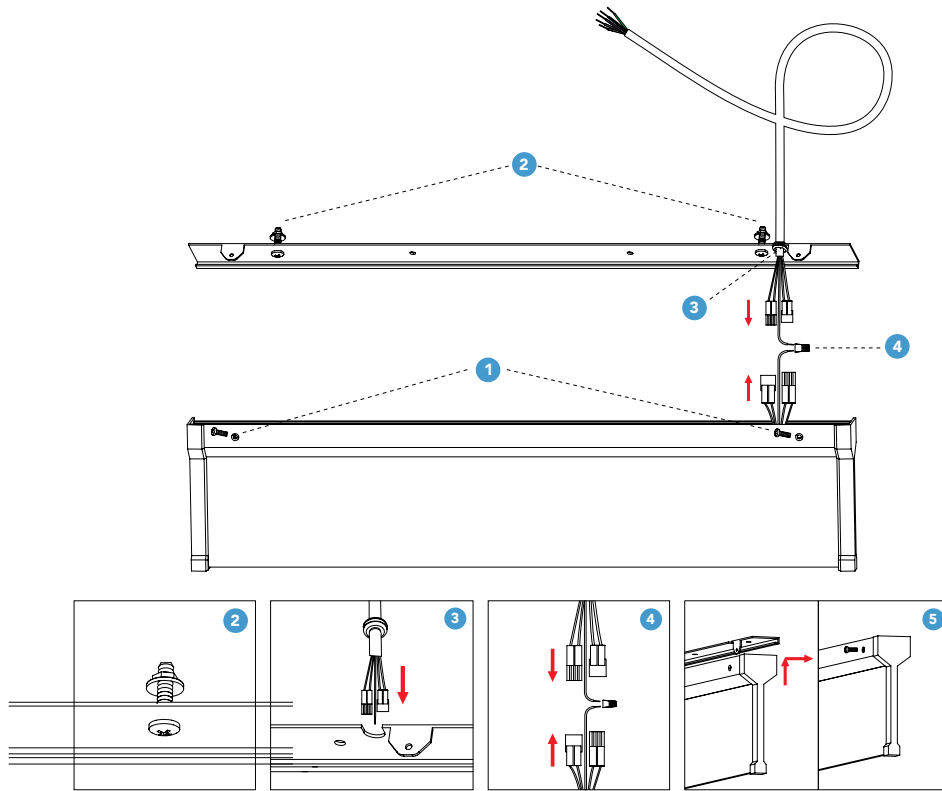

- 1 Take off the cover by screwdriver. (Please noted that there are screws & screwnuts inside the luminaire)
- 2 Assemble the screws & screwnuts as shown
- 3 Insert the power cord into the opening of cover as shown
- 4 Connect wires by quick connectors and wiring caps.
- 5 Reattach the cover by using provided into the led luminaire.
- 6 Suspend the led luminaire in the ceiling (different ceiling type use corresponding accessory).

Mounting Point

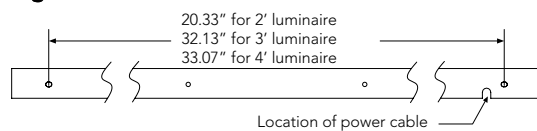

Avanta Surface Linear Installation Instructions



Dry Ceiling Pendant

Power Feed

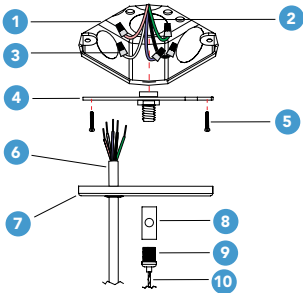

Non Power Suspension

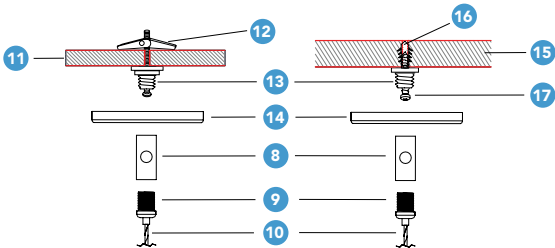

Parts List

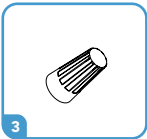

Wire nut

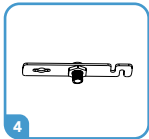

Junction Box Crossbar

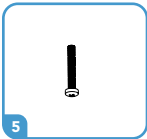

Screw PM4*22

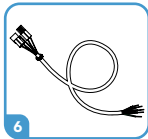

Power Cord

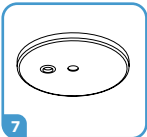

4" Canopy Power Feed

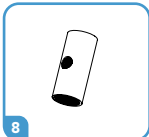

Cable Holder



Strain Relief Thread Nut

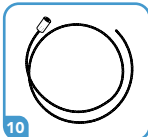

Aircraft Cable

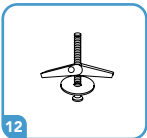

Butterfly Drywall Anchor



Crimp Stud

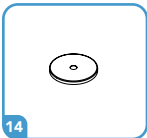

2" or 4" Canopy

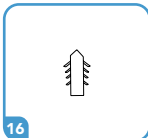

Anchor



Screw PA4*30

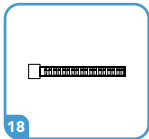

Cable Tie

| | |
|----|-------------------------------------|
| 1 | 4" Octagon Junction Box (By Others) |
| 2 | Power Cord (By Others) |
| 3 | Wire Nut |
| 4 | Junction Box Crossbar |
| 5 | Screw PM4*22 |
| 6 | Power Cord |
| 7 | 4" Power Canopy Kit |
| 8 | Cable Holder |
| 9 | Strain Relief Thread Nut |
| 10 | Aircraft Cable |
| 11 | Drywall Ceiling (By Others) |
| 12 | Butterfly Drywall Anchor |
| 13 | Crimp Stud |
| 14 | 2" Canopy |
| 15 | Solid Ceiling (By Others) |
| 16 | Anchor |
| 17 | Screw PA4*30 |
| 18 | Cable Tie |

Avanta Surface Linear Installation Instructions



Drop Ceiling Pendant

Power Feed

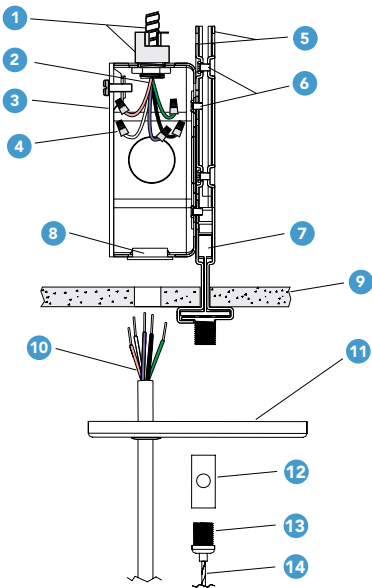

Non Power Suspension

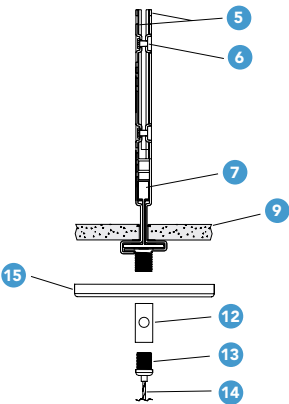

Parts List

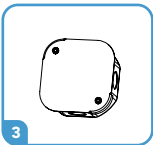

4" Octogon Junction Box

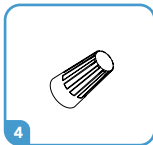

Wire Nut

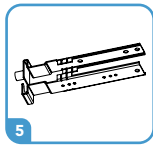

Assembled T-grid Clips



Screw 6#*4

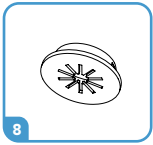

Plastic Grommet

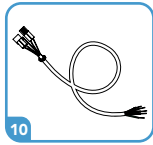

Power Cord

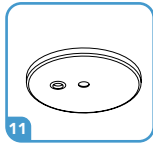

4" Canopy Power Feed

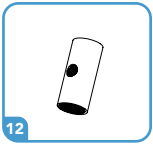

Cable Holder

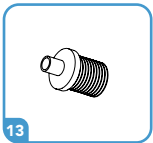

Strain Relief Thread Nut

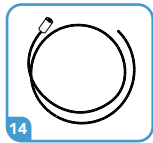

Aircraft Cable

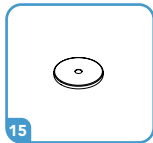

2" or 4" Canopy

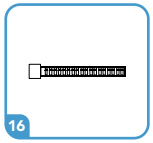

Cable Tie

| | |
|----|---------------------------------------|
| 1 | Armored Cable & Connector (By Others) |
| 2 | Power Cord (By Others) |
| 3 | 4" Octogon Junction Box |
| 4 | Wire Nut |
| 5 | Assembled T-grid Clips |
| 6 | Screw 6#*4 |
| 7 | T-grid (By Others) |
| 8 | Plastic Grommet |
| 9 | Ceiling Tile (By Others) |
| 10 | Power Cord |
| 11 | 4" Canopy Power Feed |
| 12 | Cable Holder |
| 13 | Strain Relief Thread Nut |
| 14 | Aircraft Cable |
| 15 | 2" Canopy |
| 16 | Cable Tie |