

Flood Light Elite Installation Instructions



Warning

1. To prevent personal injury or product damage only licensed electricians should install.
2. To avoid electric shock or component damage disconnect power before attempting installation or servicing.
3. This product must be installed in accordance with the national electric code (NEC) and all applicable federal, state and local electric codes and safety standards.
4. Disconnect product and allow cooling prior to servicing.
5. Any alteration or modification of this product is expressly forbidden as it may cause serious personal injury, death, property damage and/or product malfunction.
6. To prevent product malfunction and/or electrical shock this product must be properly grounded.
7. LIMIT RANGE OF ADJUSTMENT TO.
8. Suitable for operation in ambient temperatures ranging from -40°C to 40°C.
9. This product must be installed in accordance with the applicable installation code by a person familiar with the construction and operation of the product and the hazards involved.
10. Min 75°C supply conductors.
11. Suitable for mounting within 1.2 m (4 ft) of the ground.
12. This product is not available for several special environments, such as places with corrosive gas liquids or high pressure water vapor.

1/2" NPS Knuckle Mount

Optional ground stake mount pole top fitter mount

1. Install the fixture by knuckle bracket on the weatherproof Junction Box (supplied by others), and secure it by 1/2" locknut.
2. Make electrical connections from the supply ground (L/N/GND) lead to fixture ground (L/N/GND) lead respectively, making sure to follow all National Electrical Code and all applicable local codes and ordinances.
3. Aim fixture by loosening screw on knuckle of fitter and rotating fixture to desired tilt angle. Re-tighten screw.
4. While making electrical connections, ensuring water does not enter fixture through 1/2" fitter.
5. Installation and service of luminaires should be performed by a qualified licensed electrician.

CAUTION: Seal the 1/2" NPS thread using weatherproof silicone sealant while installing. This is especially important.

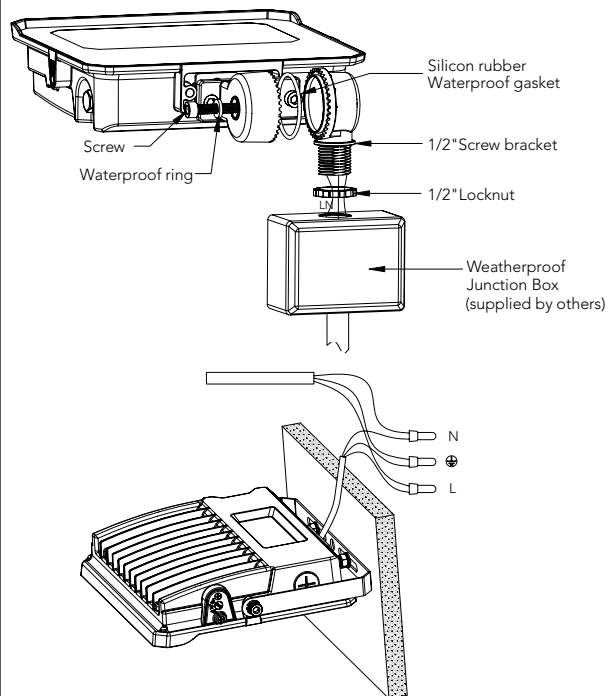

Flood Light Elite Installation Instructions



Yoke Mount

1. Mount fixture onto surface using the hole pattern provided on the trunnion bracket.
2. Make electrical connections from the supply ground (L/N GND) lead to fixture ground (L/N/GND) lead respectively, making sure to follow all National Electrical Code and all applicable local codes and ordinances
3. Aim fixture by loosening screw on knuckle of fitter and rotating fixture to desired tilt angle. Re-tighten screw.
4. While making electrical connections, ensuring water does not enter fixture through 1/2" fitter.
5. Installation and service of luminaires should be performed by a qualified licensed electrician.

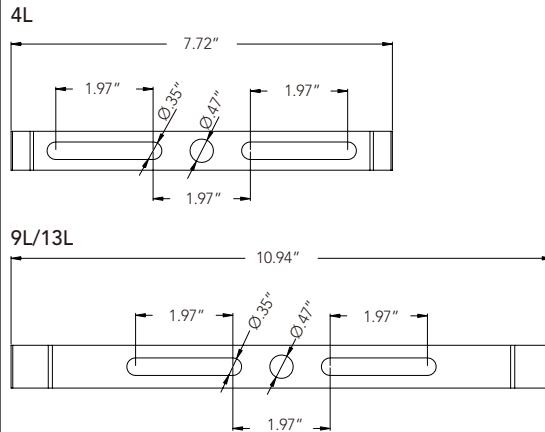

Slipfitter Mounting

1. Connect the wires to L / N / GND.
2. Remove the cover and adjust the bracket to the desired angle.
3. Install the bracket on the pole and fix it with screws.

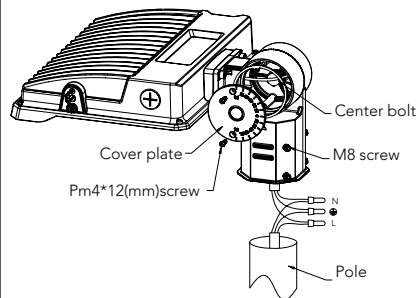

Yoke Mount Wiring

1. Connect the wires to L / N / GND
2. Mount fixture to surface using the hole pattern provided on the trunnion bracket.
3. Loosen center bolts and set screw.
4. Rotate fixture to desired aiming position and tighten center bolts.
5. Tighten set screw.
6. Refer to wiring diagrams for power connection.

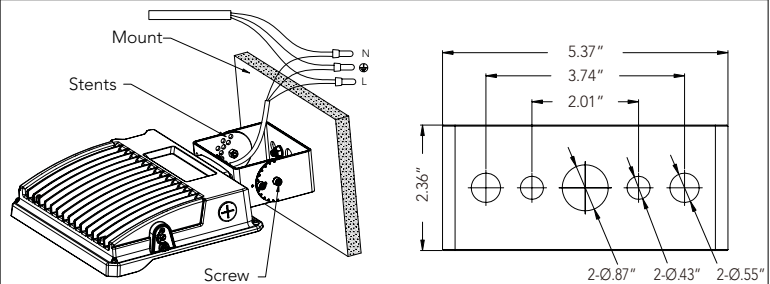

Flood Light Elite Installation Instructions



Wattage and CCT Selectable Version

1. To access Power and CCT Adjustment Control, remove the 3/4" screw plug on the back (4L) or on the right side (9L/13L/17L/22L) of the fixture.
2. Use the white switch for wattage adjustable, the middle for photo control and the black for CCT adjustable.
3. Replace the 3/4" screw plug and tighten.

Beam Angle Adjustment

Please change the beam angle of the fixture according to the instructions below. Options: 55°/ 75°/ 90°.

Factory setting: 90°

1. Choose the desired beam angle by rotating the angle adjustment device on the side of the housing.
2. Use an appropriate flat-head screwdriver/tool to adjust the beam angle.

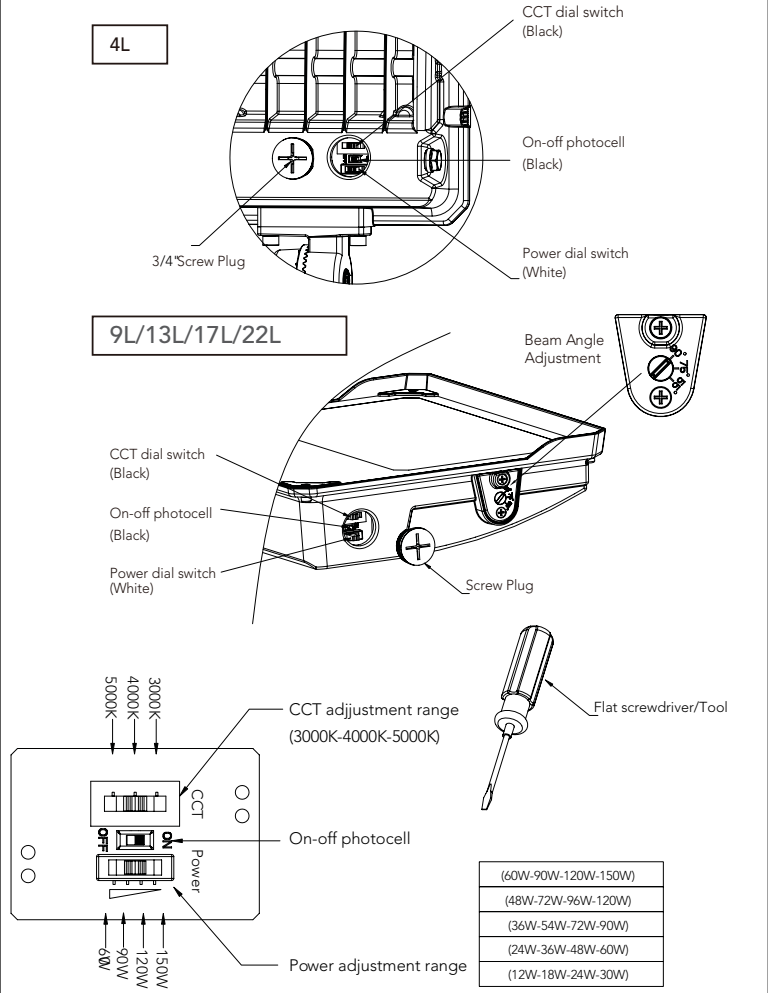

Wiring Diagram

For 0-10V Dimming Version, please refer to wiring diagram below.

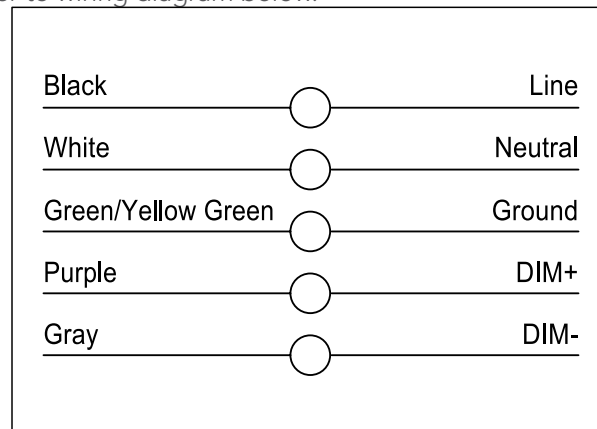

Flood Light Elite Installation Instructions



Troubleshooting

Turn off power before continuing.

1. Light does not come ON.
 - A. Check if the circuit breaker is tripped.
 - B. Confirm the wall switch is ON.
 - C. Check if the wiring to the unit is loose.
 - D. Ensure the fixture is connected to line voltage.
 - E. Confirm wiring is properly secured.
2. Light cycles ON and OFF continuously.
 - A. Check if the photocell is sensing reflected light.
3. 3. Light stays ON.
 - A. Be sure the photocell, if used, is functioning properly.

If the light still does not work after troubleshooting, contact customer service.