

2

1

REVISIONS			
REV.	DESCRIPTION	DATE	APPROVED
A	INITIAL RELEASE	11/30/16	EMJ
B	UPDATE PNS	9/1/2021	PF

ITEM NO.	PART NUMBER	DESCRIPTION	QTY.
1	CBL018	CABLE, RP-SMA F-F, 12", DOUBLE-SHIELDED	1
2	ANT-ORB-1.5-1	ANTENNA, 2.4GHZ, OUTDOOR, RIGHT ANGLE, RP-SMA MALE, 1.5dBi	1

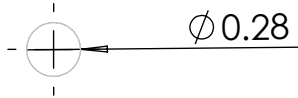

RECOMMENDED PANEL OPENING  
PANEL THICKNESS 0.25" MAX

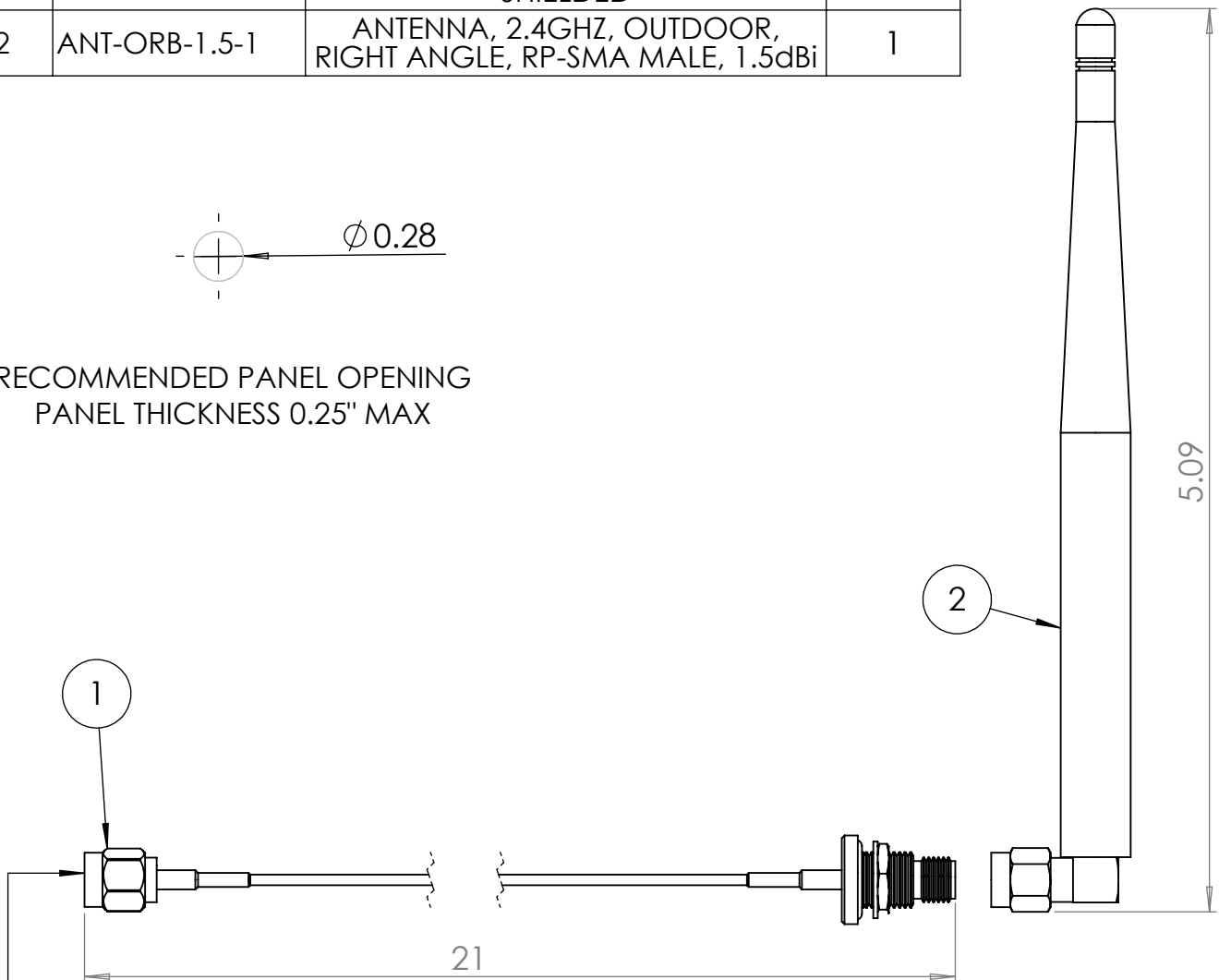

TO CONTROLLER

DIMENSIONS ARE IN INCHES  
TOLERANCES:  
FRACTIONAL  $\pm$   
ANGULAR: MACH  $\pm$  BEND  $\pm$   
TWO PLACE DECIMAL  $\pm$   
THREE PLACE DECIMAL  $\pm$

DO NOT SCALE DRAWING

**synapse** 6723 ODYSSEY DRIVE  
HUNTSVILLE AL 35806

OUTDOOR KIT,  
RIGHT-ANGLED  
ANTENNA

**PROPRIETARY AND CONFIDENTIAL**

THE INFORMATION CONTAINED IN THIS DRAWING IS THE SOLE PROPERTY OF SYNAPSE WIRELESS. ANY REPRODUCTION IN PART OR AS A WHOLE WITHOUT THE WRITTEN PERMISSION OF SYNAPSE WIRELESS IS PROHIBITED.

SIZE	DWG. NO.	REV.
A	KIT-ANT18-01	B
SCALE: 1:2	WEIGHT:	SHEET 1 OF 1

2

1