

# Keilton + autani

## IFS108-AUX Series

Luminaire Mount



IFS108-AUX.B1

### Description

The Keilton IFS108 series are designed for Luminaire Level Lighting Control (LLLC/ NLC5) with integrated daylight harvesting and PIR motion sensor which can convert general luminaires into smart lighting fixture. The compact structure is designed for panel, troffer lighting fixtures.

### Features

- PIR sensor
- Daylight harvesting
- Small form factor
- ALgoH<sup>2</sup>** to maximize detection without false triggers

### Requirements

- Requires dim to off luminaire driver
- SC05, 2.5mm AUX socket (not included)

### Specifications

Input Voltage	DC 12V
Input Current	25mA Max
Input Power	0.3W
Bluetooth Transmit	100ft Max
Radio Frequency	2.4GHz ± 75MHz
Bluetooth Version	5.0
Housing Material	UL 94-5VA
Indoor/Outdoor Use	Indoor Use Only
Operating Temperature	-30°C to 55°C, -22°F to 131°F
Storage Temperature	-30°C to 85°C, -22°F to 185°F
IP Rating	IP20
Color	White
Warranty	5 year warranty
Compliance	UL8750, RoHs
Safety	cULus Listed E504054 Low Bay Sensor FCC ID: 2A26YLTkTVT2022 DLC: NLTRC5KL0TN

### Ordering Information

Model	Description
IFS108-AUX.B1	Fixture mounted Sensor-2.5mm Audio Jack Base
SC05	2.5mm audio style jack receptacle for IFS108E-AUX.B1

### Wiring

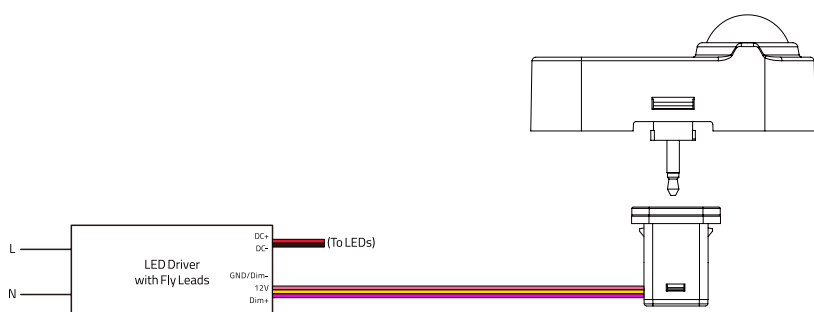

## Dimensions

Unit: inch/mm

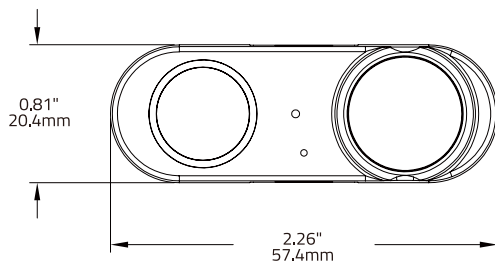

Coverage Side View

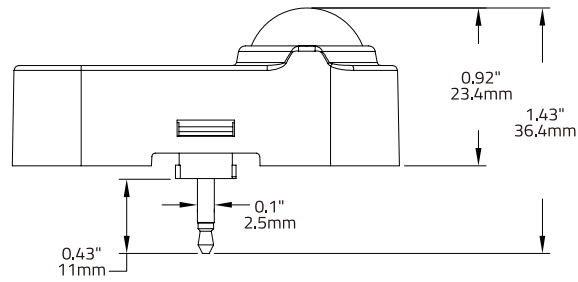

Coverage Top View

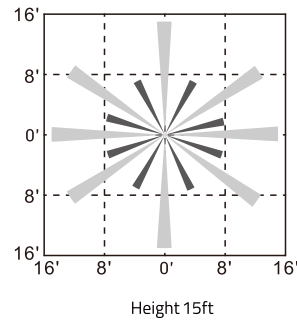
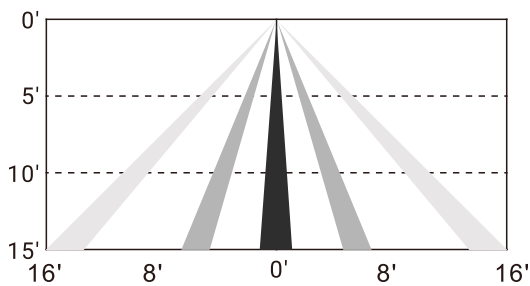

Height 15ft

## Product Label



The Bluetooth word mark and logos are registered trademarks owned by Bluetooth SIG, Inc. and any use of such marks by LiteTrace is under license. Other trademarks and trade names are those of their respective owners.

## App Download



Due to our continued efforts to improve our products, specifications are subject to change without notice.

## Contact Us

7001 Columbia Gateway Drive, Suite 210, Columbia, MD 21046, USA

T: +1 443-320-2233 (M-F 9am-5pm ET)

E: support@autani.com