

Avanta Square Up/Down Installation Instructions

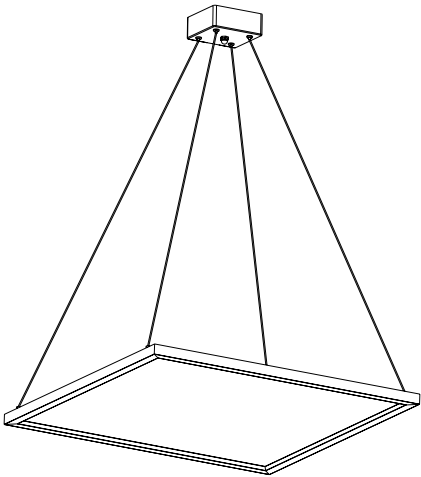

Warning

RISK OF FIRE AND ELECTRICAL SHOCK. FIXTURE MUST BE INSTALLED BY A QUALIFIED ELECTRICIAN ONLY IN ACCORDANCE WITH NATIONAL, LOCAL BUILDING AND ELECTRICAL CODES. DISCONNECT POWER AT ELECTRICAL PANEL BEFORE SERVICING.



Important

1. Read all instructions.
2. Install in accordance with national and local electrical code regulations.
3. This product is intended to be installed and serviced by a qualified, licensed electrician.
4. Do not install in wet locations. For dry and damp use only.
5. Turn off electrical power before installing or servicing fixture in any way.
6. To reduce the risk of fire and overheating, make sure all connections are tight.
7. Under no circumstances can the lighting fixture be covered with heat insulation gasket or similar materials.

Attention

Leave the protective films on the fixtures until construction and furniture are complete.

SHOCK HAZARD!
May result in serious injury or death. Turn power OFF at circuit breaker prior to installation or servicing.

Wiring Diagram

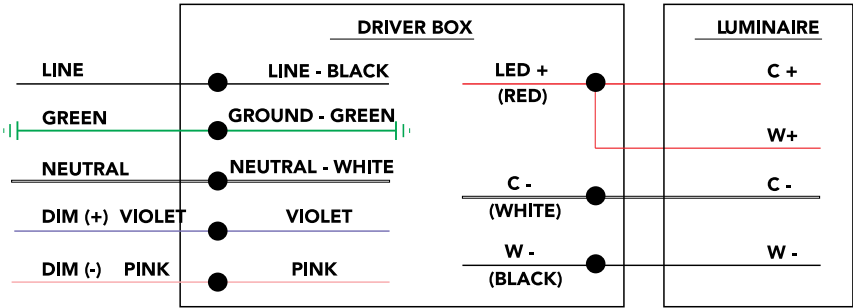

Avanta Square Up/Down Installation Instructions



Dry Ceiling Power Feed

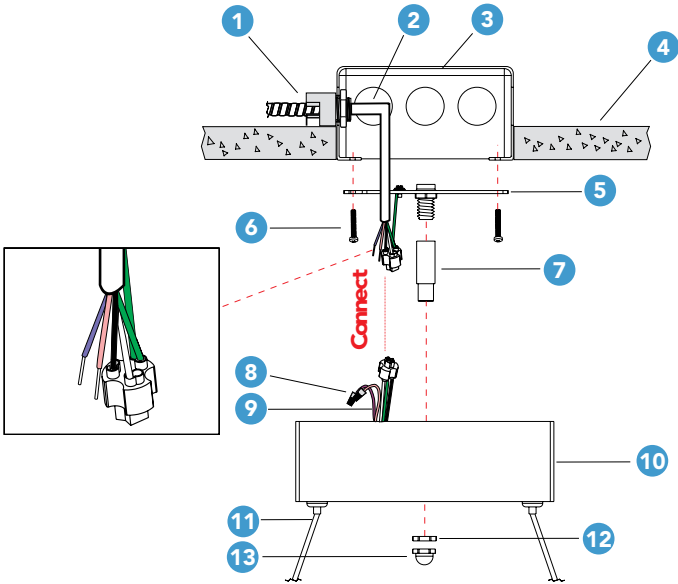

⚠ Connect DC wires correctly according to the label.

Parts List

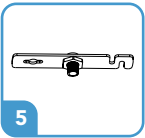

Junction Box Crossbar

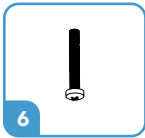

Screw NO.8-32UNC,4*22

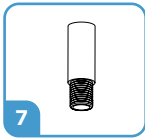

Cable Holder

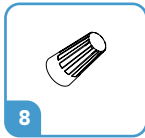

Wire Nut

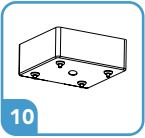

Driver Box

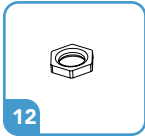

Hex Nut

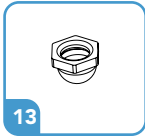

Nut

1	Armored Cable & Connector (By Others)
2	AC Input (By Others)
3	J-Box (By Others)
4	Drywall Ceiling (By Others)
5	Junction Box Crossbar
6	Screw NO.8-32UNC,4*22
7	Cable Holder
8	Wire Nut
9	AC Input Of Driver
10	Driver Box
11	DC Input
12	Hex Nut
13	Nut

Avanta Square Up/Down Installation Instructions



Drop Ceiling - T-Grid Clips

Power Feed

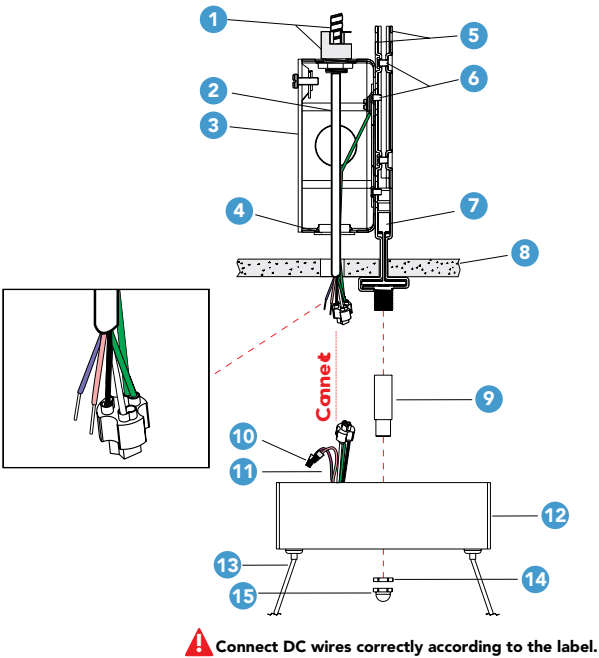

Parts List

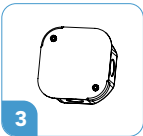

4" Octogon junction Box

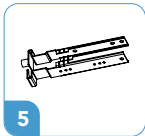

Assembled T-grid Clips

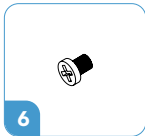

Screw 6#*4

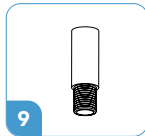

Cable Holder

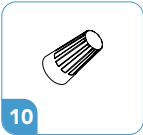

Wire Nut

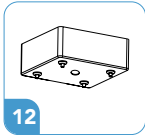

Driver Box

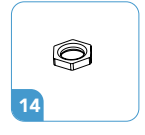

Hex Nut



Nut

1	Armored Cable & Connector (By Others)
2	Power Cord (By Others)
3	4" Octogon Junction Box
4	Plastic Grommet
5	Assembled T-grid Clips
6	Screw 6#*4
7	T - grid (By Others)
8	Ceiling Tile (By Others)
9	Cable Holder
10	Wire Nut
11	AC Input Of Drive
12	Driver Box
13	DC Input
14	Hex Nut
15	Nut

Avanta Square Up/Down Installation Instructions



Installation Instructions

1. Install the J-box crossbar

Secure the J-box crossbar (5) on the J-Box by screw (6).

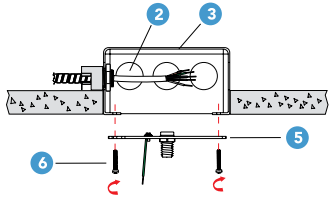

2. Install cable holder

Screw the cable holder on to the J-box crossbar.

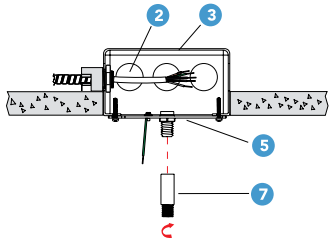

3. DC Wiring

- Pass the four DC input cables of the lamp through the four connectors at the bottom of the driver box to the inside of the driver box.
- Connect the DC output cable in the driver box to the four DC input cables of the lamp using a wire nut (8) according to the label on the DC cable.

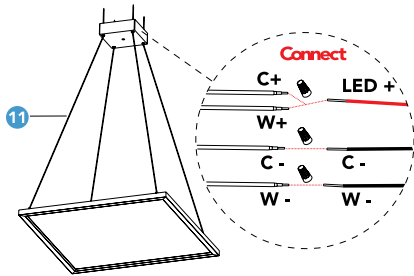

4. AC Wiring

- Insert the AC input cable (2) and the green ground cable in the J-box crossbar into the female connector in the driver box according to the corresponding color, so that the AC input cable is correctly connected to the AC input cable of the power supply.
- Connect the dimming wires with a wire nut.

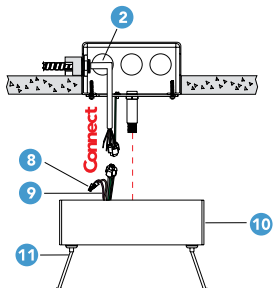

Avanta Square Up/Down Installation Instructions



5. Secure the drive box

Cover the driver box on the ceiling, pass the cable holder (7) on the J-box crossbar through the middle hole of the power box, and then screw with nuts (12) and (13) in turn to secure the driver box.

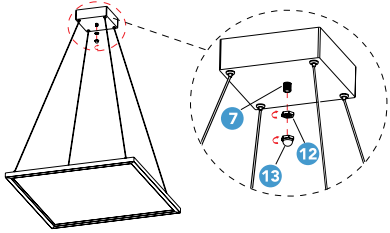

6. Complete

